



TWINPOWER 3  
SERIES





415W  
PW-415-BMD-HV



### TWINPOWER 3 SERIES

Powerwave has redefined the high-efficiency module series by integrating 182mm silicon wafers with multi-busbar and half-cut cell technologies. Powerwave panels combine creative technology effectively and extremely improved the module efficiency and power output.

### KEY FEATURES

-  Less mismatch to get more power
-  Less power loss by minimizing the shading impact
-  Competitive low light performance
-  3 times EL test to ensure best quality
-  Ideal choice for utility and commercial scale projects by reduced BoS and improved ROI

### QUALITY SYSTEM

ISO9001 / ISO14001 / ISO45001

### PRODUCT CERTIFICATION





### INSURANCE

**PICC**

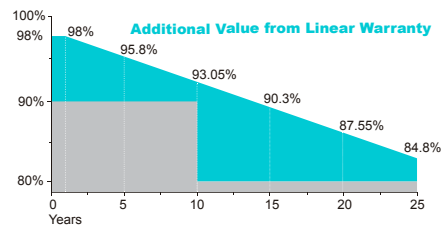
### WARRANTY



 Guarantee on product material and workmanship

 Linear power output warranty



BACKED BY  
**TRADEZONE**  
Save time. Save money.  
AUSTRALIA'S LARGEST  
ONLINE ELECTRICAL WHOLESALER

1800 092 778

sales@tradezone.com.au

131 Millaroo Drive, Helensvale, Gold Coast, Australia

### Electrical Characteristics

| Module Type                  | PW-415-BMD-HV |       |
|------------------------------|---------------|-------|
|                              | STC           | NOCT  |
| Maximum Power at STC (Pmp)   | 415           | 311   |
| Open Circuit Voltage (Voc)   | 37.42         | 34.90 |
| Short Circuit Current (Isc)  | 13.90         | 11.23 |
| Maximum Power Voltage (Vmp)  | 31.16         | 29.19 |
| Maximum Power Current (Imp)  | 13.32         | 10.66 |
| Module Efficiency at STC(ηm) | 21.25         |       |
| Power Sorting Tolerance      | 0-4.99W       |       |
| Maximum System Voltage       | 1500V DC      |       |
| Maximum Series Fuse Rating   | 25 A          |       |

STC: Irradiance 1000 W/m<sup>2</sup> module temperature 25°C AM=1.5  
 Power Measurement Tolerance: +/- 3%

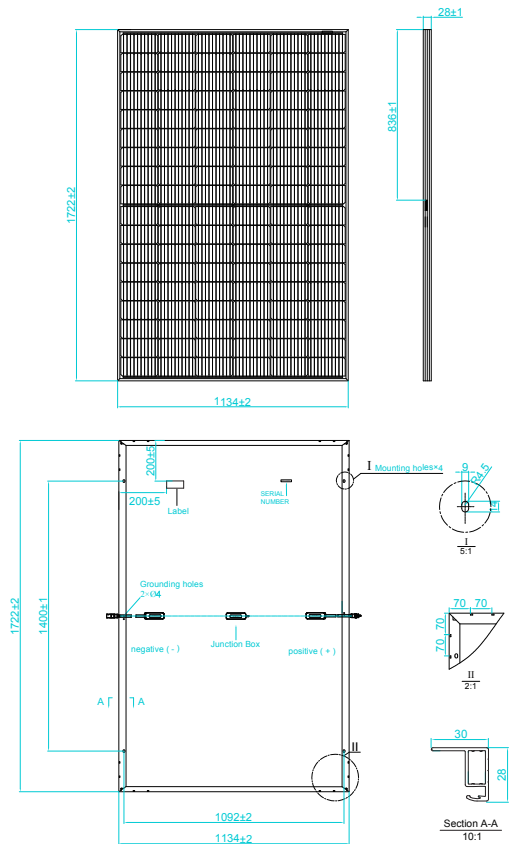

### Temperature Characteristics

|  |              |
|--|--------------|
| Pmax Temperature Coefficient             | -0.34 %/°C   |
| Voc Temperature Coefficient              | -0.26 %/°C   |
| Isc Temperature Coefficient              | +0.05 %/°C   |
| Operating Temperature                    | -40 ~ +85 °C |
| Nominal Operating Cell Temperature(NOCT) | 45±2 °C      |

### Mechanical Specifications

|                     |   |
|---------------------|---|
| External Dimensions | 1722 x 1134 x 28 mm   |
| Weight              | 19.0 kg   |
| Solar Cells         | PERC Mono (108 pcs)   |
| Front Glass         | 3.2mm AR coating tempered glass, low iron                   |
| Frame               | Black anodized aluminium alloy                              |
| Junction Box        | IP68, 3 diodes  |
| Output Cables       | 4.0mm <sup>2</sup> , 250mm(+)/350mm(-) or Customized Length |
| Connector           | Genuine MC4   |
| Mechanical Load     | Front side 5400Pa/ Rear side 2400Pa                         |
| Fire Safety Class   | Class C   |

### I-V Curve

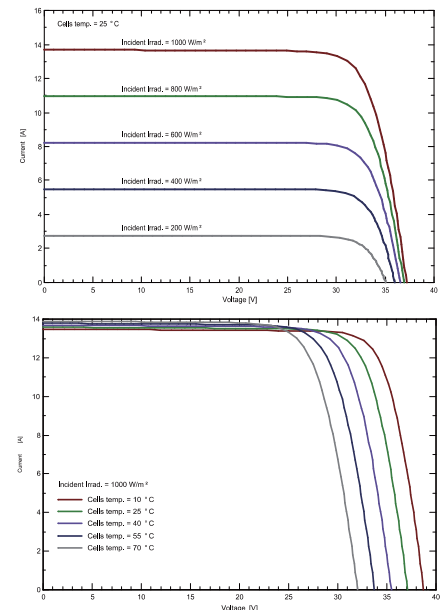

### Packing Configuration

|                       | 1722 x 1134 x 28 mm |       |
|-----------------------|---------------------|-------|
| Container             | 20'GP               | 40'HQ |
| Pieces per Pallet     | 39                  | 39    |
| Pallets per Container | 6                   | 26    |
| Pieces per Container  | 234                 | 1014  |

For details, please consult Powerwave.

## Made In China

Specifications are subject to change without further notification



1800 092 778

sales@tradezone.com.au

131 Millaroo Drive, Helensvale, Gold Coast, Australia